

US-LT40B SERIES SCREW DRIVERS

EXPLODED VIEW

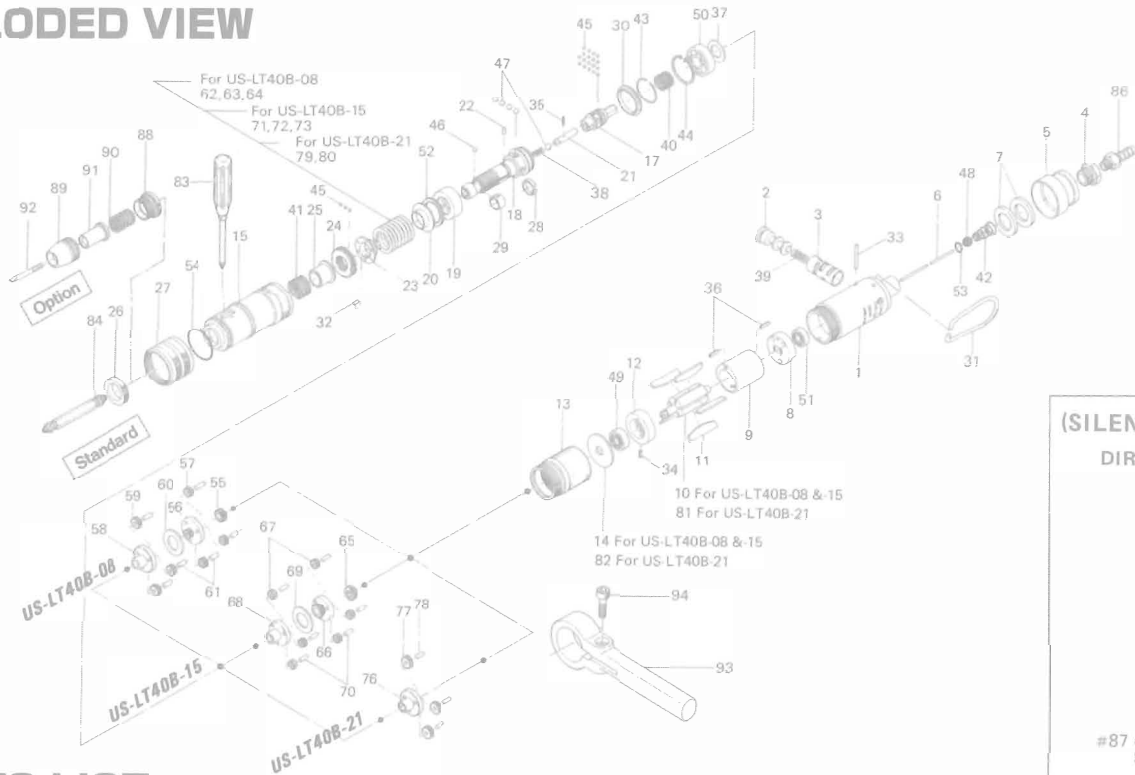

PARTS LIST

Index No.	Code No.	Parts Name	Quantity	Index No.	Code No.	Parts Name	Quantity	Index No.	Code No.	Parts Name	Quantity
US-LT40B series Common Parts				#39	976-147-0	Spring (7×12)	1	#68	472-485-5	Second Gear Case	1
# 1	472-025-7	Casing	1	#40	976-332-0	Spring (13.5×10)	1	#69	496-483-1	Gear Case Spacer	1
# 2	893-057-1	Reverse Valve (Lock)	1	#41	976-450-0	Spring (18.5×10)	1	#70	972-089-0	Needle Roller (3×8)	6
# 3	472-211-7	Reverse Valve Bushing	1	#42	977-157-0	Cone Spring (7×11×20)	1	#71	976-516-0	Spring (22.1×28) (Standard)	1
# 4	480-091-8	Air Inlet Bushing	1	#43	978-218-0	Snap Ring (22×1)	1	#72	976-515-0	Spring (22.7×28)	1
# 5	472-782-7	Exhaust Deflector	1	#44	979-326-0	Inner Snap Ring (IRTW-26)	1	#73	976-517-0	Spring (21.5×31) Yellow	1
# 6	472-104-7	Valve Rod	1	#45	981-001-0	Ball (3/32)	21	(Option : Strong)			
# 7	472-835-7	Filter	2	#46	981-002-0	Ball (1/8)	1	#74	976-517-0	Spring (21.5×31) Yellow	1
# 8	472-285-7	Rear Plate	1	#47	981-004-0	Ball (3/16)	5	(Option : Weak)			
# 9	472-286-7	Cylinder	1	#48	981-208-0	Ball (5/16) (Black)	1	#10	472-287-7	Rotor	1
#11	472-288-0	Blade (PC)	5	#49	982-063-0	Ball Bearing (606ZZ)	1	#14	472-807-7	Spacer	1
#12	472-289-7	Front Plate	1	#50	982-100-0	Ball Bearing (6000)	1	Parts for US-LT40B-21			
#13	472-029-7	Gear Casing	1	#51	987-039-0	Miniature Ball Bearing (R-1560 ZZ)	1	#76	472-480-3	Gear Case	1
#15	472-369-7	Clutch Casing	1	#52	944-019-0	Back-up Ring (P-19)	1	#77	472-470-3	Planet Gear	3
#17	472-346-5	Cam	1	#53	990-005-0	O-Ring (P-7)	1	#78	972-089-0	Needle Roller (3×8)	3
#18	472-319-7	Anvil	1	#54	990-923-0	O-Ring (SNS-26)	1	#79	976-517-0	Spring (21.5×31) (Standard)	1
#19	472-375-7	Cam Ring	1	Parts for US-LT40B-08				#80	976-516-0	Spring (22.1×28) Red	1
#20	472-379-8	Retainer	1	#55	472-460-7	Rotor Gear	1	(Option : Strong)			
#21	471-318-5	Pilot Pin	1	#56	472-480-7	First Gear Cage	1	#81	472-287-3	Rotor	1
#22	471-764-7	Notch Pin	1	#57	472-470-7	First Planet Gear	3	#82	472-807-3	Spacer	1
#23	472-562-8	Spring Holder	1	#58	472-485-7	Second Gear Case	1	Accessories			
#24	472-257-8	Regulating Screw	1	#59	472-471-7	Second Planet Gear	3	#83	939-402-0	Manual Driver (No.2)	1
#25	472-351-7	Bit Sleeve	1	#60	496-483-1	Gear Case Spacer	3	#84	916-810-0	(+)Double Bit (No.2×75)	1
#26	472-567-7	Bushing	1	#61	972-089-0	Needle Roller (3×8)	6	#86	940-113-0	Air Hose Nipple	1
#27	472-370-7	Clutch Casing Sleeve	1	#62	976-515-0	Spring (22.7×28) (Standard)	1	Optional Accessories			
#28	471-670-7	Band	1	#63	976-516-0	Spring (22.1×28)Red	1	#93	472-516-7	Reaction Bar	1
#29	471-356-7	Bit Band	1	(Option : Weaker)			1	#94	945-222-0	Hexagon Bolt (M6×22)	1
#30	463-334-7	Anvil Spacer	1	#64	976-517-0	Spring (21.5×31)Yellow	1	For Direct Type			
#31	010-790-1	Suspension Ring	1	(Option : Weakest)			1	#87	496-088-1	Silencer Assembly	1
#32	970-092-0	Pin (2×5.5)	1	#10	472-287-7	Rotor	1	For Slotted Head Bit and Finder			
#33	970-105-0	Pin (2×24)	1	#14	472-807-7	Spacer	1	(Take out 472-567-7 Bushing, firstly.)			
#34	973-006-0	Roll Pin (2×6)	1	Parts for US-LT40B-15				#88	472-082-7	Bit Casing Set Screw	1
#35	969-470-0	Pin (2×8)	1	#65	472-460-5	Rotor Gear	1	#89	471-057-7	Bit Casing	1
#36	973-010-0	Roll Pin (2×10)	2	#66	472-480-5	First Gear Cage	1	#90	976-330-0	Spring (13.8×18)	1
#37	975-106-0	Spacer (18.5×11×1)	1	#67	472-470-5	Planet Gear	6	#91	917-350-0	Finder (7.3×56×24)	1
#38	976-058-0	Spring (4.5×11)	1					#92	916-030-0	(-)Bit (5×56)	1

When ordering spare parts, please specify tool type, code number and part name.

Printed in Japan



URYU SEISAKU, LTD. Osaka Japan

For further information, please contact at any time your nearest URYU distributor.

OKA-249-03-11-04-2016