

US-LT20 SERIES SCREW DRIVERS

EXPLODED VIEW

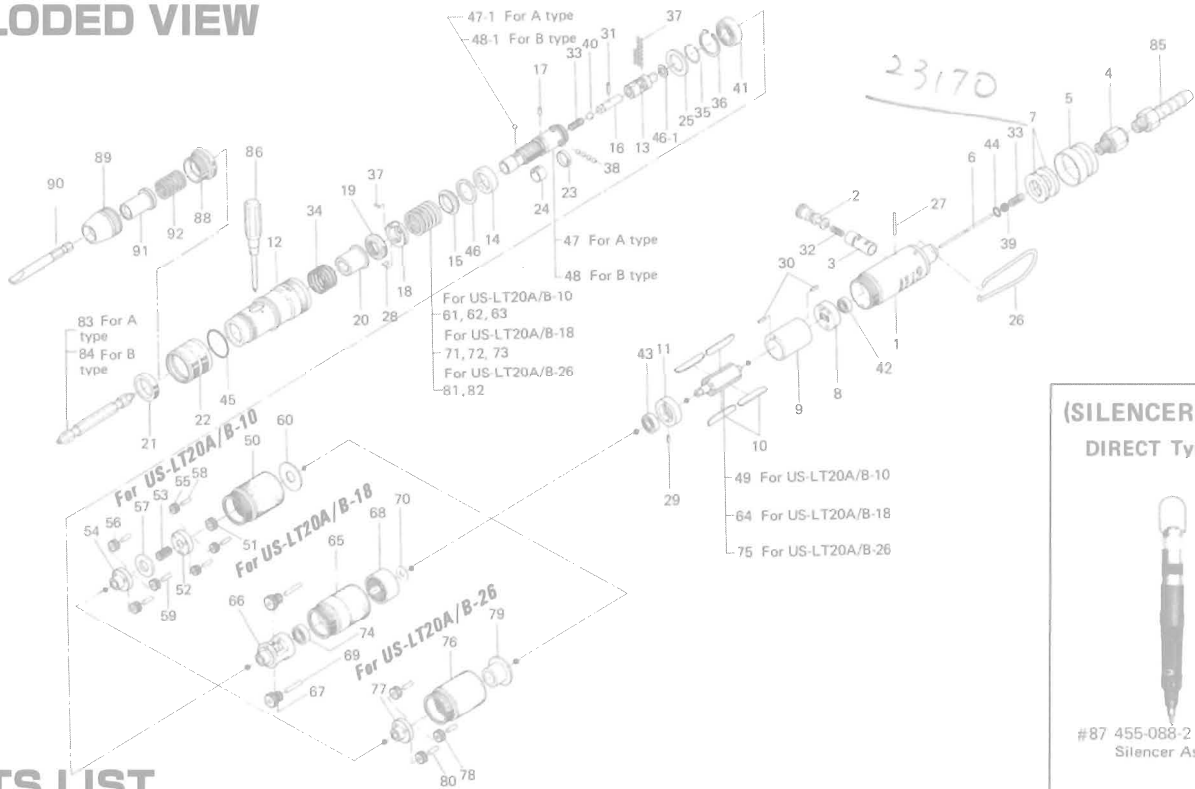

PARTS LIST

Index No.	Code No.	Parts Name	Quantity	Index No.	Code No.	Parts Name	Quantity	Index No.	Code No.	Parts Name	Quantity
Common Parts for US-LT20 series				#38	981-002-0	Ball (1/8)	4	Parts for US-LT20A-18 and US-LT20B-18			
# 1	470-025-8	Casing	1	#39	981-206-0	Ball (1/4)	1	#64	470-287-6	Rotor	1
# 2	893-055-1	Reverse Valve (Lock)	1	#40	981-004-0	Ball (3/16)	1	#65	470-029-6	Gear Casing	1
# 3	470-211-8	Reverse Valve Bushing	1	#41	982-036-0	Ball Bearing (699)	1	#66	470-480-6	Gear Cage	1
# 4	405-091-1	Air Inlet Bushing	1	#42	987-038-0	Miniature Ball Bearing (R-1140ZZ)	1	#67	470-470-6	Planet Gear	2
# 5	455-782-1	Exhaust Deflector	1	#43	987-041-0	Miniature Ball Bearing (R-1350ZZ)	1	#68	470-465-6	Internal Gear	1
# 6	470-104-8	Valve Rod	1	#44	990-903-0	O-Ring (SNS-5)	1	#69	972-037-0	Needle Roller (2.5×15)	2
# 7	470-835-8	Filter	2	#45	990-918-0	O-Ring (SNS-20)	1	#70	975-009-0	Spacer (9×5.2×0.3)	1
# 8	470-285-8	Rear Plate	1	#46	944-014-0	Back-up Ring (P-14)	1	#71	976-431-0	Spring (Standard:18×20)	1
# 9	470-286-8	Cylinder	1	#46-1	470-344-8	Cam Spacer	1	#72	976-432-0	Spring (Strong:18×20)	1
#10	470-288-1	Blade (PC)	4	Parts for US-LT20A series				#73	976-430-0	Spring (Weak:17.5×20)	1
#11	470-289-8	Front Plate	1	#47	470-319-3	Anvil	1	#74	987-013-0	Miniature Ball Bearing (R-1350)	1
#12	470-369-9	Clutch Casing	1	Parts for US-LT20B series				Parts for US-LT20A-26 and US-LT20B-26			
#13	470-346-8	Cam	1	#47-1	981-155-0	Ball (3.5)	1	#75	470-287-6	Rotor	1
#14	470-375-9	Cam Ring	1	Parts for US-LT20A-10 and US-LT20B-10				#76	470-029-8	Gear Casing	1
#15	470-164-9	Spring Setter	1	#49	470-287-8	Rotor	1	#77	470-480-4	Gear Cage	1
#16	470-318-8	Pilot Pin	1	#50	470-029-8	Gear Casing	1	#78	471-470-3	Planet Gear	3
#17	470-764-8	Notch Pin	1	#51	470-460-8	Rotor Gear	1	#79	470-483-4	Gear Cage Spacer	1
#18	470-562-8	Retainer	1	#52	470-480-8	First Gear Cage	1	#80	972-033-0	Needle Roller (2.5×8)	3
#19	470-257-8	Regulating Screw	1	#53	470-445-8	Middle Gear	1	#81	976-430-0	Spring (Standard:17.5×20)	1
#20	470-351-7	Bit Sleeve	1	#54	470-485-8	Second Gear Cage	1	#82	976-431-0	Spring (Strong:18×20)	1
#21	470-567-7	Bushing	1	#55	470-470-8	First Planet Gear	3	ACCESSORIES			
#22	470-370-8	Clutch Casing Sleeve	1	#56	470-471-8	Second Planet Gear	3	#83	916-710-0	(+)Double Bit (No.2×70)for A-type	1
#23	470-670-8	Band	1	#57	471-483-7	Gear Cage Spacer	1	#84	916-810-0	(+)Double Bit (No.2×75)for B-type	1
#24	470-356-8	Bit Band	1	#58	972-008-0	Needle Roller (2×8)	3	#85	940-103-0	Air Hose Nipple	1
#25	975-153-0	Spacer (21×14.5×1)	1	#59	972-033-0	Needle Roller (2.5×8)	3	#86	939-402-0	Manual Driver No.2 (φ5)	1
#26	401-790-1	Suspension Ring	1	#60	975-151-0	Spacer (22×8×1.5)	1	For Direct Type			
#27	970-017-0	Pin (H) (1.5×18)	1	#61	976-432-0	Spring (Standard:18×20)	1	#87	455-088-2	Silencer Assembly	1
#28	970-091-0	Pin (H) (2×4.5)	1	#62	976-431-0	Spring (Weaker:18×20)	1	For Slotted Head Bit and Finder			
#29	973-000-0	Roll Pin (1.5×4)	1	#63	976-430-0	Spring (Weakest:17.5×20)	1	#88	470-082-8	Bit Casing Set Screw	1
#30	973-001-0	Roll Pin (1.5×6)	2								
#31	973-003-0	Roll Pin (1.5×8)	1								
#32	976-048-0	Spring (4×10)	1								
#33	976-058-0	Spring (4.5×11)	2								
#34	976-427-0	Spring (17.5×10)	1								
#35	978-150-0	Snap Ring (15×1)	1								
#36	979-320-0	Inner Snap Ring (IRTW-20)	1								
#37	981-000-0	Ball (1/16)	22								
<p>When ordering spare parts, please specify tool type, code number and part name.</p>											



URYU SEISAKU, LTD. Osaka Japan